

MR

Patentiertes Entleerklappen
 Abdichtsystem
 Patented Discharge Flap
 Sealing System

Mixer MR

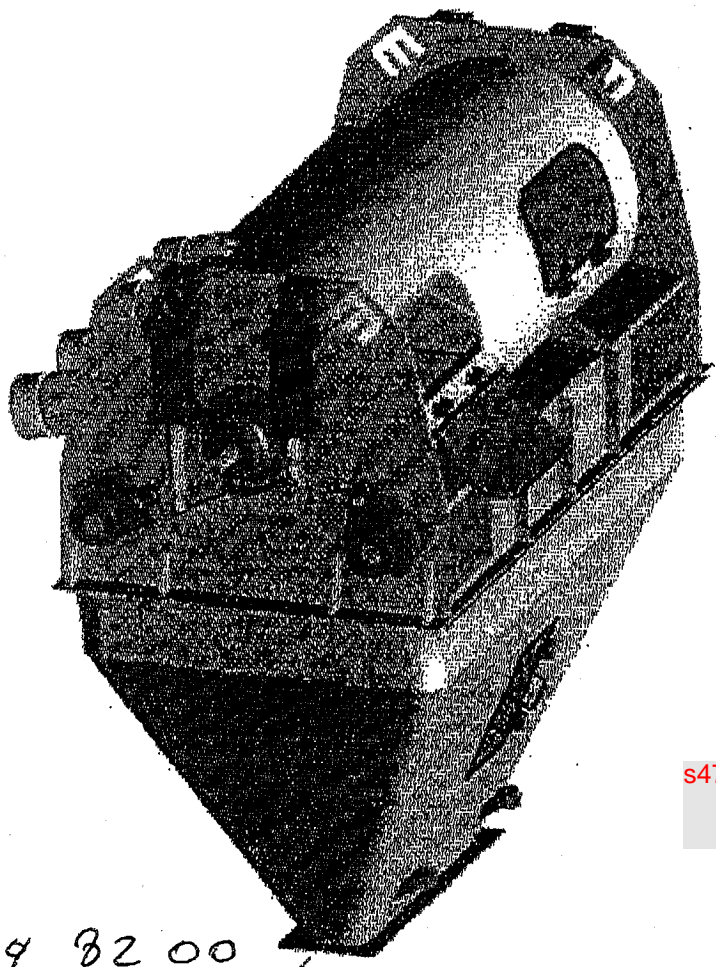

ABN 33003418086
 S/Code: 4810066N

2/8
 s47F

8474 8200 /38 NO
 MIXING MACHINE

DUTY
 50%
m-tec

MIR

Innovative Development

Knee-lever system for the drive of the discharge flaps

- ▶ Up to 70% less energy consumption, pneumatically and hydraulically
- ▶ Mechanical locking of the flaps, keep closed to 100% also at pressure drop
- ▶ Shortest discharge times approx. 10 sec. through large opening speed and big flaps.

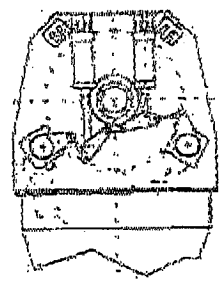

Special-flap-sealing

- ▶ No material pressing on the sealing parts possible through mechanical self-cleaning effect.
- ▶ Perfect function, also at sticking products with large content of moisture
- ▶ Max. useful life through special-actuator
- ▶ Segmentally changeable, lowest service costs.

Optimal service

- ▶ Larger service flaps on the mixing drum
- ▶ Large agitator-flange, installation and removal without gear tool dismantling possible

Tough construction

- ▶ Design of the most important building parts with the help of most modern FEM-calculation.

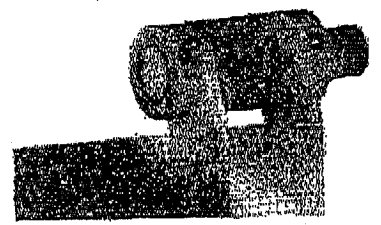

Mixing - plant - making capacity												
Typ	MR 11	MR 22	MR 45	MR 65	MR 90	MR 150	MR 220	MR 310	MR 400	MR 610	MR 840	MR 1100
Mixer volume (l)	110	220	485	680	900	1500	2300	3100	4000	6100	8400	11000
Mixer volume (m ³)	38	65	135	195	270	450	690	930	1300	1840	2620	3300
Mixer output (t/h)	1500	25	35	45	55	70	85	95	110	145	200	285
	900	25	35	45	55	70	85	95	110	145	200	285
batch time (min)	25	35	45	55	70	85	95	110	145	200	285	440

System Overview

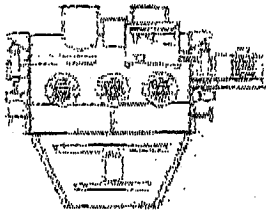

Mixer type MR/ME

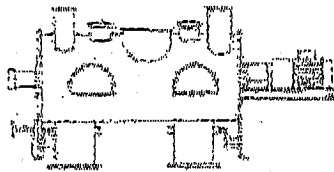

Mixer type MS

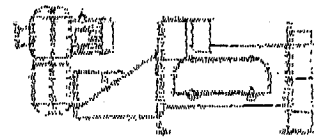

Mixer type MD

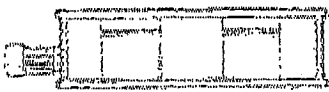

Cellular wheel station

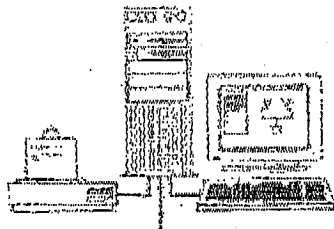

Control technology

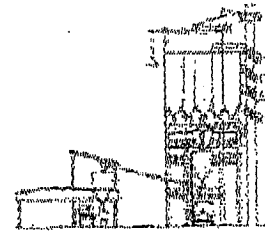

Mixing power plant

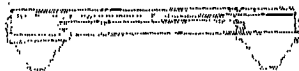

Air lock conveyor

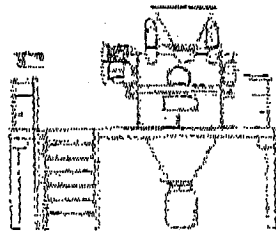

Small mixing plant



Laboratory mixer

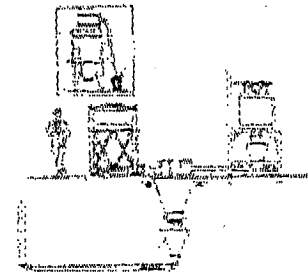

Exchangeable container system

0100-0000-0000



m-tec machines technology mbh

City: Hülba-Gräfen 6
D-70385 Neuenburg
www.m-tec-gmbh.de

Phone: +49 7631 399-0
Fax: +49 7631 399-130
Email: info@m-tec-gmbh.de

Mixer

Well-know and proven advantages

For the most difficult mixing tasks

- ▶ Careful product mixing
- ▶ No grain destruction and material pressing between mixing tools and mixer housing
- ▶ Centrifugal blades turn out a 3-dimensional particle movement
- ▶ Homogeneous mixture at a short mixing time with trade number 8-9
- ▶ Agitator with special tools for the supply of disintegration of color pigments or agglomerates.

Two large discharge flaps on the complete drum length with 100° opening angle

- ▶ Residue-free emptying down to less than thousandth parts

Long-lasting and easy-to-maintain mixing shaft sealing

- ▶ Long useful life through special-elastomer with grease-lubrication
- ▶ 3 sets of pre-assembled reserve seals on the mixing shaft.

Long useful life

- ▶ Wear resisting design of mixing device and mixing drum available

Low building height due to 2-flap-construction

- ▶ Reduced steel construction costs of the complete plant.

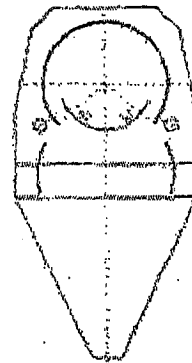
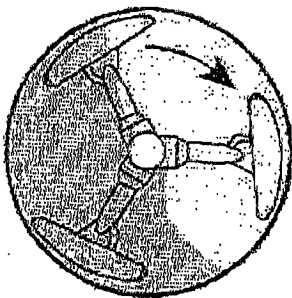

The art of mixing

- PARTEC

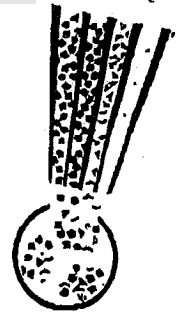

s47F

Flexible and intelligent solutions
for every application.

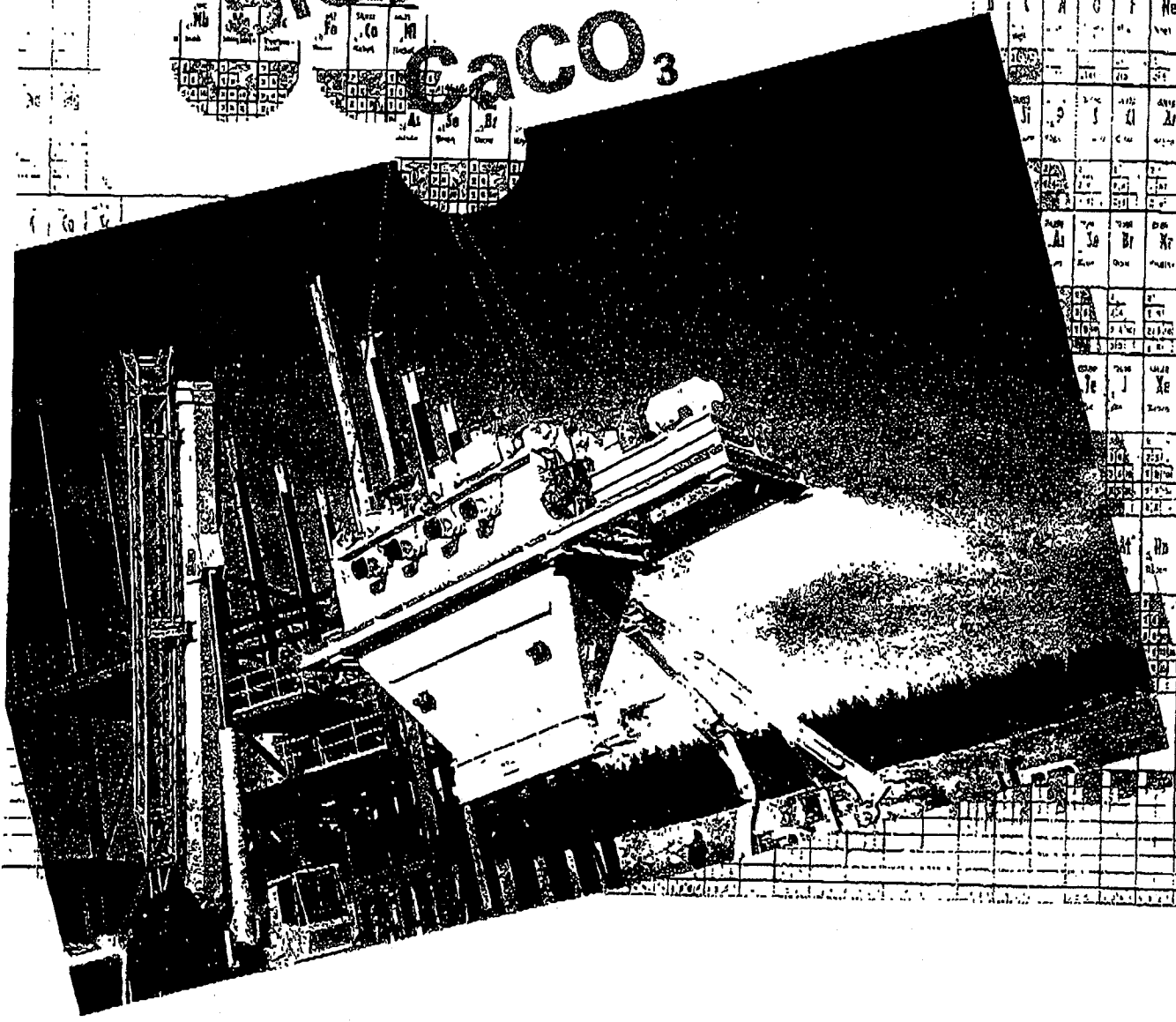
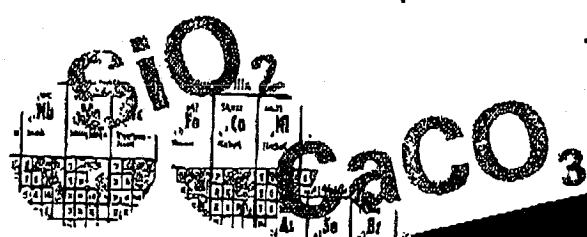

m-tec[®]

The art of practicable mixing lies in the system solution: designed and realised all in one.

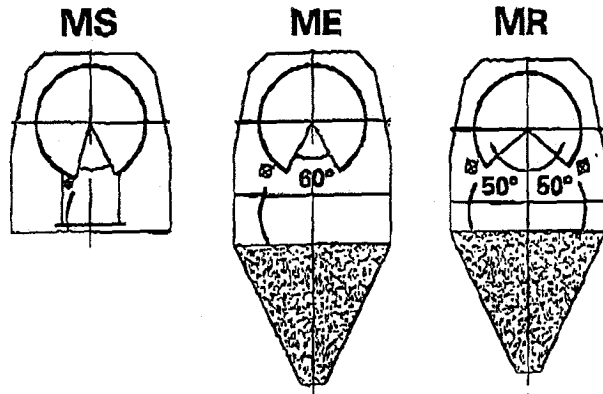

Mixing Systems

m-tec offers mixing systems both for batch and continuous operation and is always aiming to keep the best mixing quality first and foremost.

m-tec batch mixers are different because of their discharge system. For applications where discharge time and demand for residue free discharge are not a priority the nozzle discharge MS mixer is used. This is available with one or more nozzles according to the size of the mixer. For applications where rapid discharge is required, the m-tec ME mixer is used. The double flap MR mixer was designed for products which require quick and residue free discharge. The MD continuous mixer is used for continuous processes.

Uses range from mixing dry or damp materials as well as powders and all types of coarse grained bulk materials. m-tec mixers are tried and tested and achieve a distinctly higher and more consistent mixing quality in the shortest mixing time whilst also lasting longer. The same applies to extreme mixing ratios of up to 1:100,000. m-tec mixers are supplied with a net capacity from 11 up to 11,000 litres. Other sizes are available as required.

Mixers are made from normal steel, stainless steel or wear resistant steel according to the area of application.

If pigments, fibres or even products that are difficult to disperse (agglomerates) are to be mixed, then specially shaped, separately driven high speed agitators are also utilised.

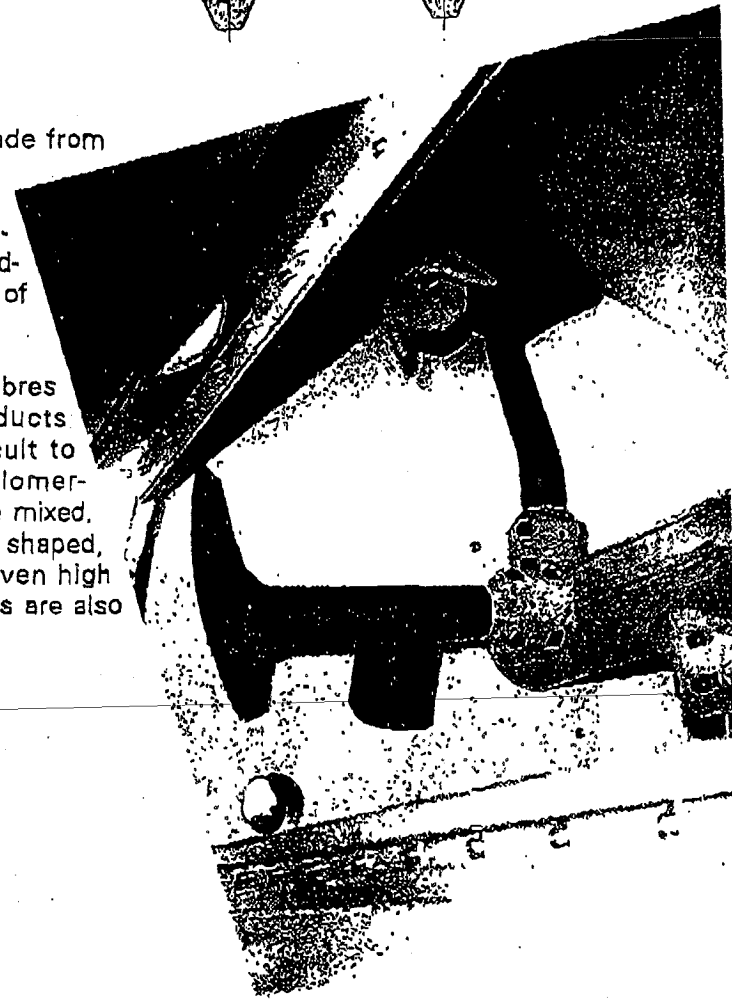

At m-tec the emphasis is on innovation. In 1983 m-tec were the first in mixing technology to launch onto the market a single shaft horizontal batch mixer with residue free discharge. In 1990 the design was developed to improve the stiffness of the flaps using a box construction.

In 1995 in the field of dry building materials m-tec introduced an innovative self locking knee joint construction for activating the discharge flaps. In 1998 m-tec's product range was extended with the launch onto the market of the single flap mixer and the self cleaning seal

System Solution:

Compact

m-tec supplies compact mixing plants for the production of specialised products at between 1 - 10 t/h. Initially these plants are semi-automatic. Dosing and weighing the main components as well as bagging can also be automated at a later stage. In the final stage of extension the m-tec FAD system doses and weighs the additives. They are then pneumatically conveyed to the mixer. m-tec MS, ME or MR batch mixers can be installed as desired.

Typical areas of application for compact mixing plants:

- Chemicals
- Building materials
- Ceramics
- Food stuffs

- Convincing advantages:
- Compact construction
 - Modular extension
 - Simple design

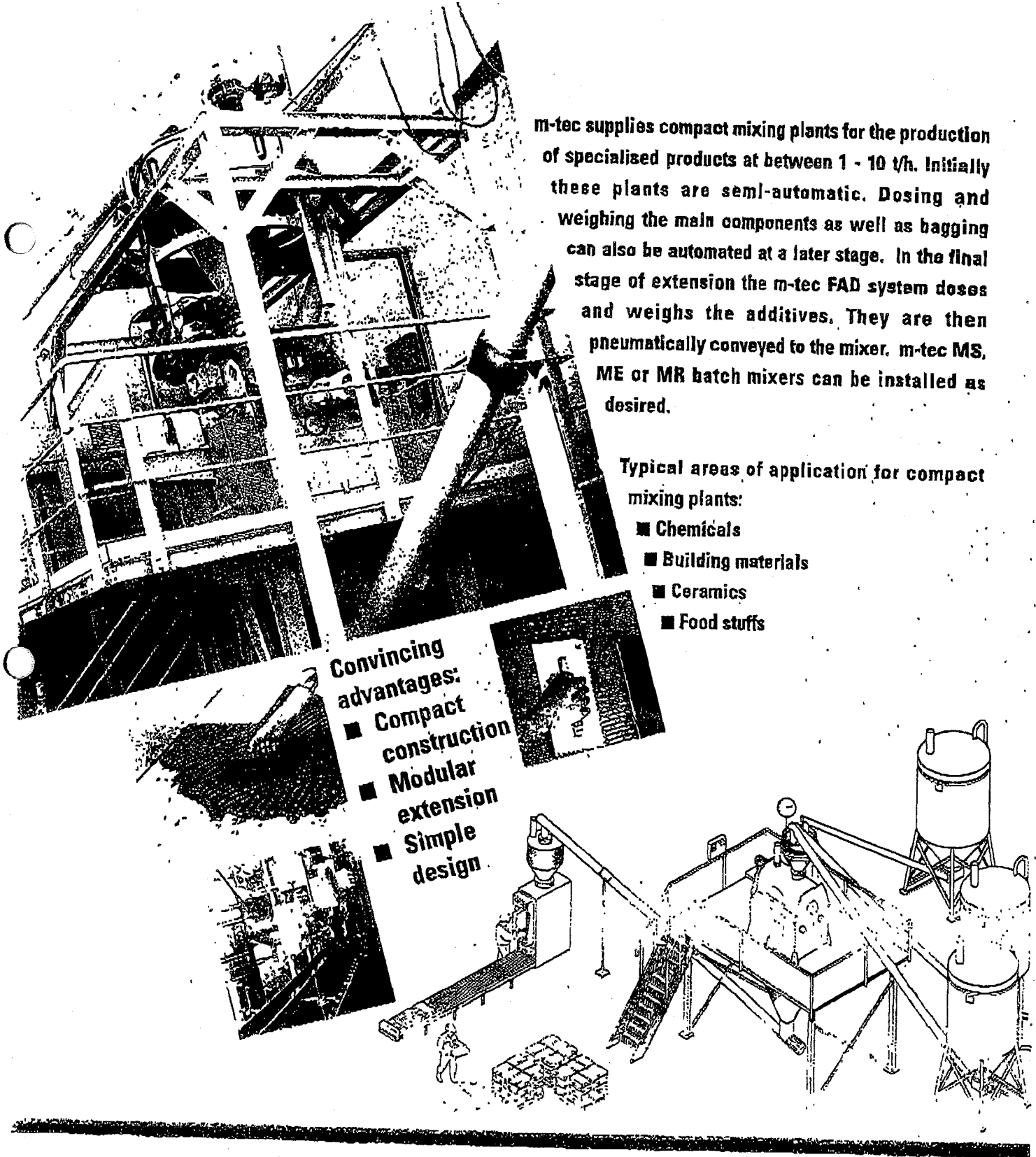

10

m-tec mixing and plant technology supplies good value semi- and fully automatic mixing plants for every level of output. m-tec know how begins with market research right through to analysing available raw materials and developing recipes that suit a particular market. This allows the best plant design and the necessary control systems to be conceived.

The correct choice of plant components guarantees a high quality standard. m-tec's logistics system ensures dry bulk solids or building materials get to the right place at the right time. The m-tec processing technology and service package complete the picture.



033 933 1000

MelChem Pty Ltd
 PO Box 284 Dingley, Victoria 3172 Australia
 Telephone +61 3 9551 1966
 Facsimile +61 3 9551 1977

m-tec®